

Catalog

- 1. Product naming rules**
- 2. Features**
- 3. Application range**
- 4. Radiation Pattern**
- 5. Typical Optical/Electrical Characteristics Curves**
- 6. Absolute Maximum Ratings**
- 7. Package Dimensions**
- 8. Welded plate Dimensions**
- 9. Label**
- 10. Tape Specifications**
- 11. Reflow soldering instructions**
- 12. Use the matters needing attention**



ATTENTION
 OBSERVE PRECAUTIONS
 FOR HANDLING
 ELECTROSTATIC
 DISCHARGE
 SENSITIVE
 DEVICES

	●

Product naming rules

o

Features

x x

100ns

Application range

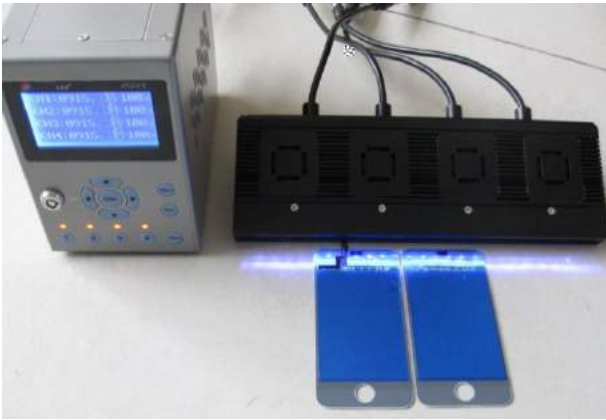

UV
UV Curing

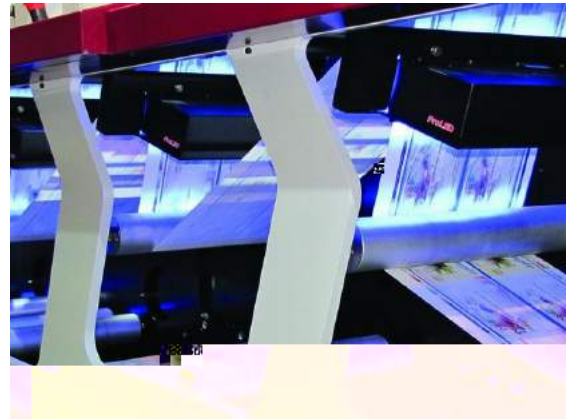

UV
UV Printing



UV
UV Exposure

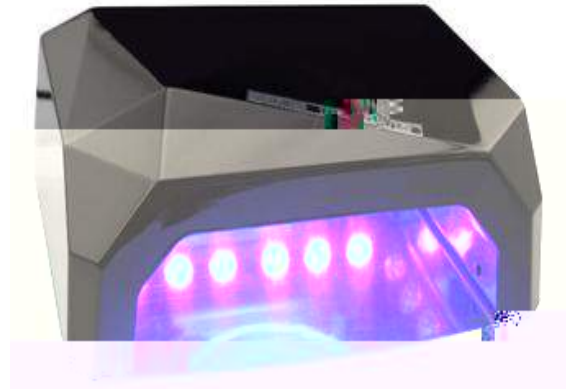

Nail Polish Curing



Security, Banknote



Mosquito Killer

Radiation Pattern

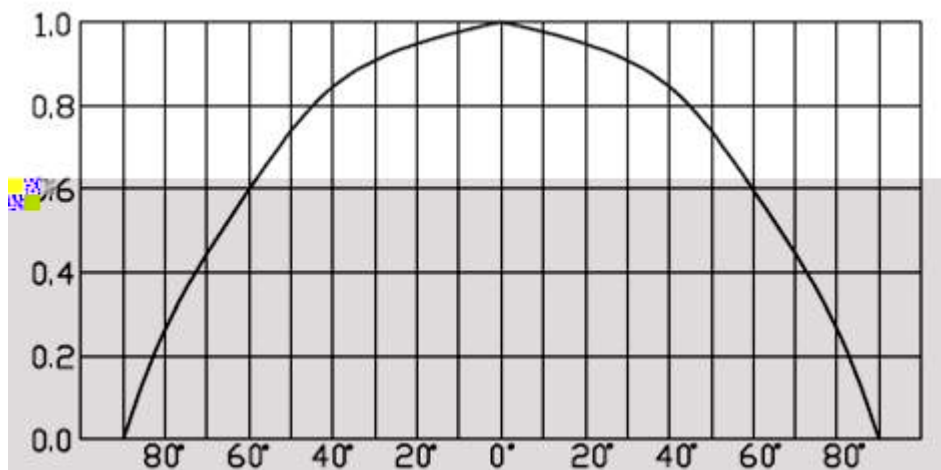
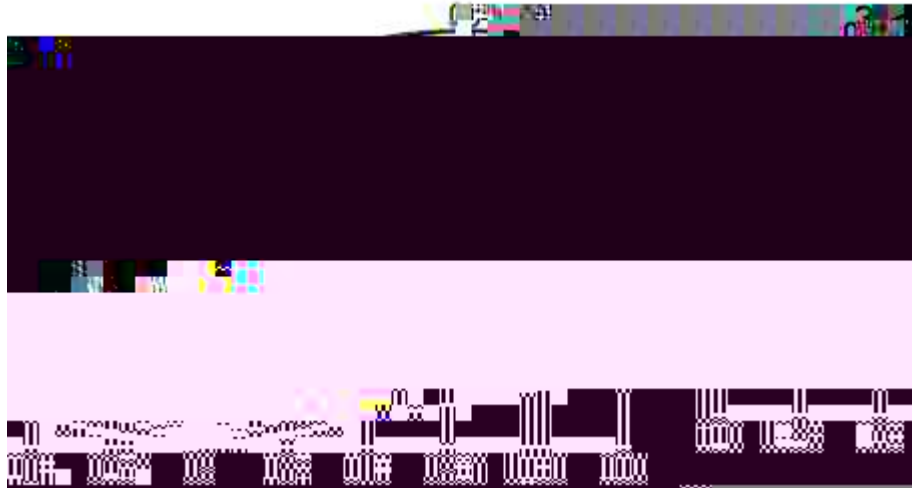

Typical Optical/Electrical Characteristics @Ta=25±7 °HmdY

Symbol	Item	Min.	Typ	Max.	Units	
	辐射功率					
	正向电压					

Absolute Maximum Ratings 绝对最大额定值@H51&)±7

Item名称	Symbol 符号	Absolute Maximum Rating 绝对最大额定值	
			20°C To +60°C
			0C To +40°C

Notes注:

1. Radiant flux measurement tolerance: ±10%;
2. Forward measurement tolerance: ±3%;
3. Peak wavelength measurement tolerance: ±3nm;
 .1/10 Duty Cycle, 0.1ms Pulse Width. 1/10占空比, 0.1ms脉冲宽度;
5. The temperature of Aluminum PCB do not exceed 55°C. 基板温度不超过55°C。

Typical Optical/Electrical Characteristics Curves ($T_a=25^\circ\text{C}$ Unless Otherwise Noted)

典型光学/电性特征曲线 ($T_a=25^\circ\text{C}$ 除非另有注释)

(1) Wavelength Characteristics

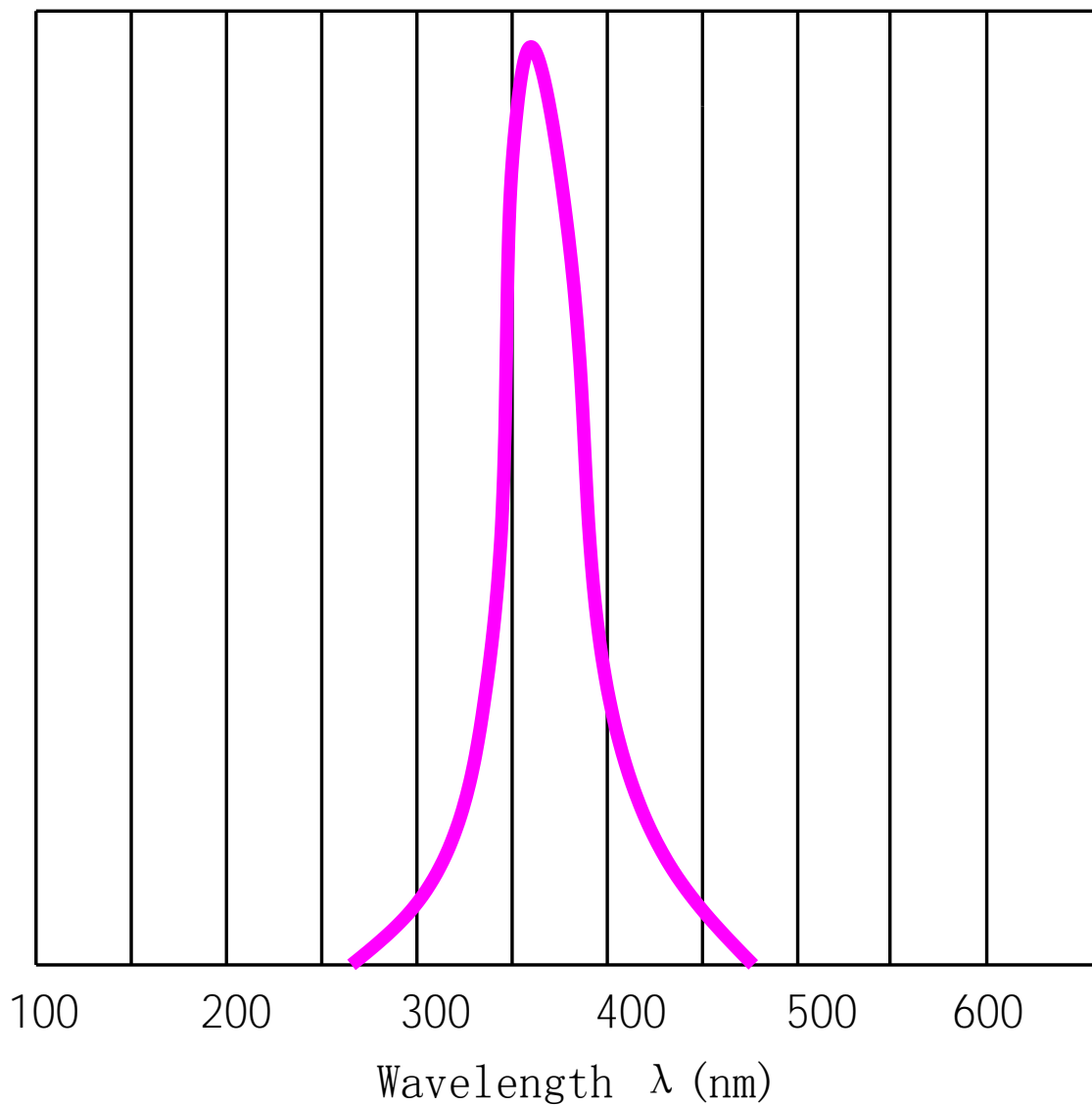

(2) Relative Radiation Flux-IF

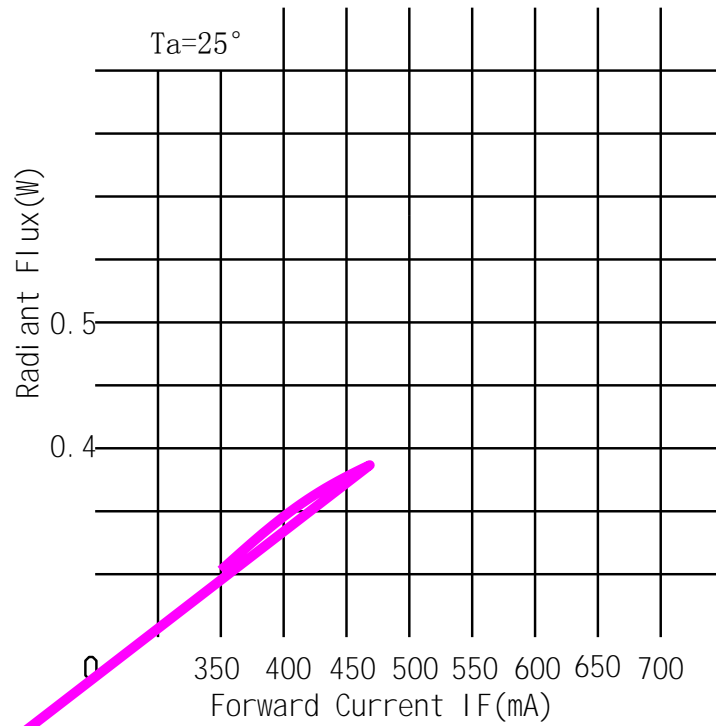

(3) Relative IF-VF

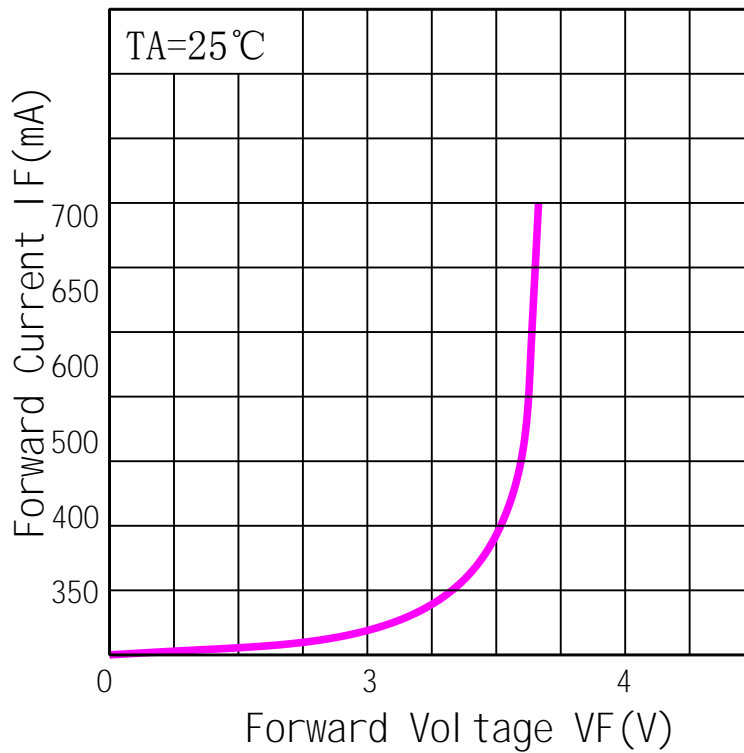

(4) Allowable Forward Current-Ta

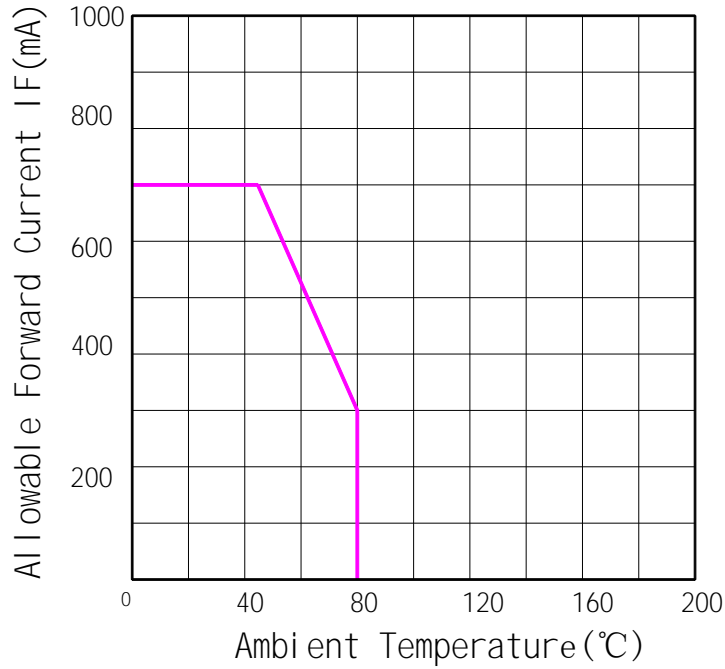

(5) Radiation Flux-Ta

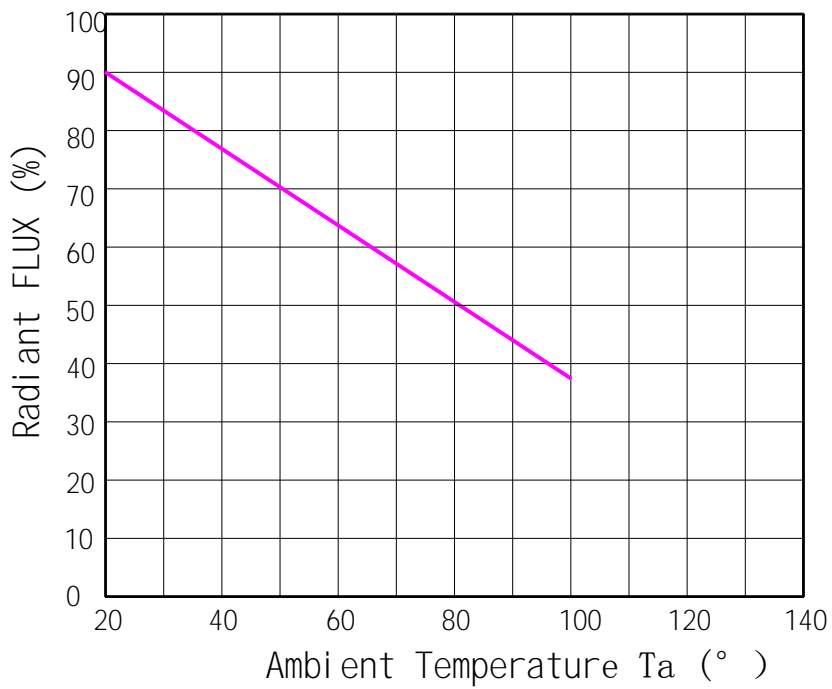

Package Dimensions

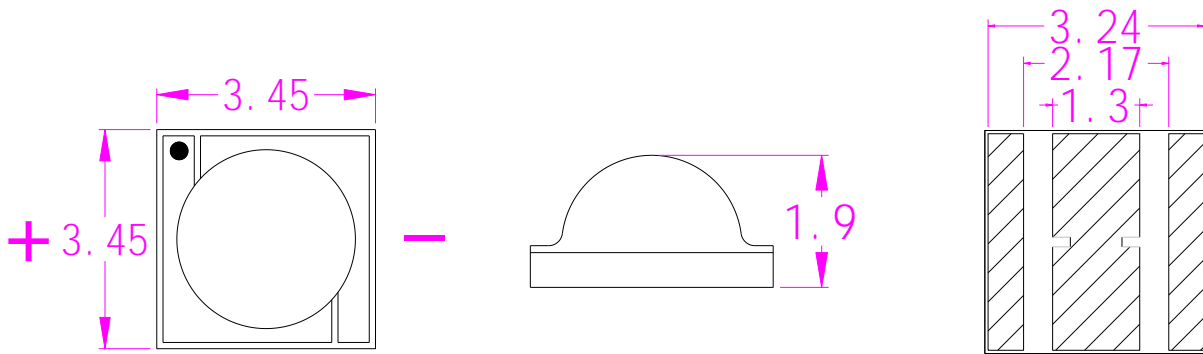

Notes :

2. All dimension tolerance is $\pm 0.1\text{mm}$ unless otherwise noted.

Welded plate Dimensions

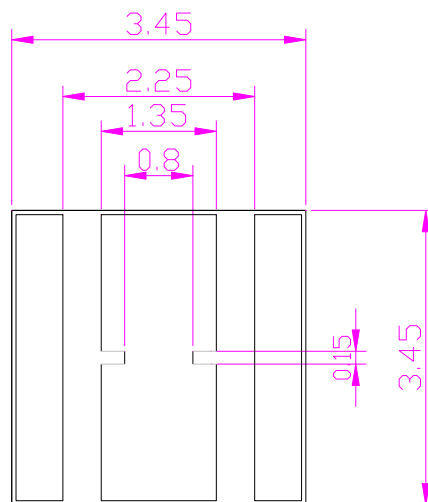

Notes :

Label

:

	HONGLITRONIC 鸿利光电	RoHS
TYPE:		QTY:
VF:		e:
IF:		P:
DATE		LOT. NO:

Tape Specifications(Units:mm)

(

(

1000 pcs/

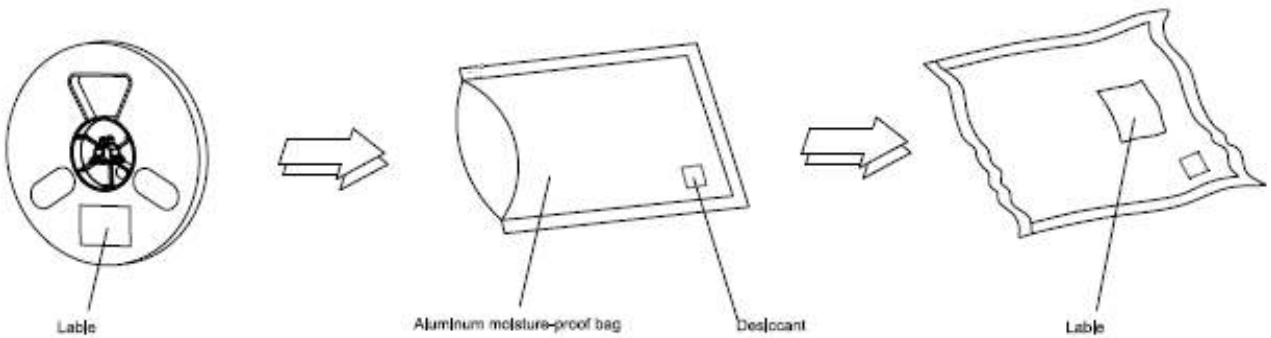
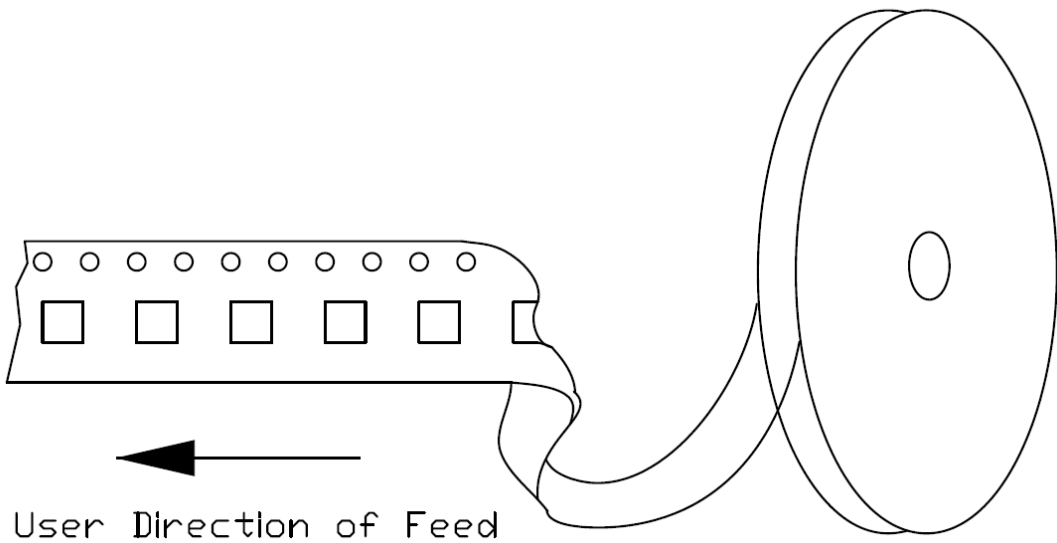
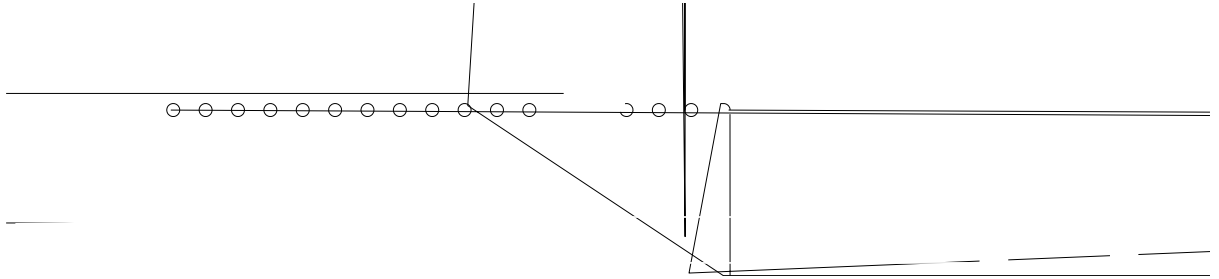

Reflow soldering instructions

Profile Feature

Lead-Free Solder

Lead-Free Solder



Note:

210°C-220°C

145°-165°-185°-210°-220°-240°-260°-240

210°C-220°C

90cm/min

°C

Use the matters needing attention(使用注意事项)

storage)

LED	24H	5-30 °C	60%
		60 °C ±5 °C	12H

To avoid moisture, we recommend storage conditions for the unopened LED +5 ~ +30 °C, relative humidity <60%. LED should be used within 168 Hrs. of opening the package. Please make sure to dehumidify and vacuum pack the remaining/ unused LED. Dehumidifying condition: +120 °C ±5 °C, 04 Hrs. Effective age for the sealed led is one year.

the assembly notes)

1000g	260 °C.
-------	---------

Soldering Conditions This product must be used reflow soldering practices, the maximum temperature of reflow should not exceed 220 °C. Please make sure when soldering, there is no external force on the soldering surface (such as pressure, friction or sharp metal nails, etc.), to avoid gold wire deformation or damage and other abnormalities.

If beyond recommended conditions, we cannot guarantee the LED stability, please do the risk assessment first.

anti-Static Measures)

Please take adequate measures to prevent electrostatic generation, such as wearing electrostatic ring or anti-static fingerstall etc; any relative products like plant equipment, machinery, carrier and transportation units shall be connected to discharging unit/ ground. After assembly, please make sure to discharge Static Electricity with proper ESD equipment.

temperature Control)

500V

During assembly, please ensure that a good quality thermal paste is applied and distributed evenly over the surface. While using thermal pad (Heat Sink), make sure LED is firmly tightened and there is no gap between surfaces. The need to ensure the cooling medium dielectric withstand test at least through 500V.

drive control)

other)

(Cl₂, H₂S NH₃ SO_x NO_x

Product is not suitable to use in following conditions;

- Direct or indirect wet / damp conditions, such as rain, etc;
- in contact with sea water and erosive materials;
- Exposed to corrosive gases (e.g., Cl₂, H₂S, NH₃, SO_x, NO_x, etc.);
- Exposed to dust, liquids or oils;

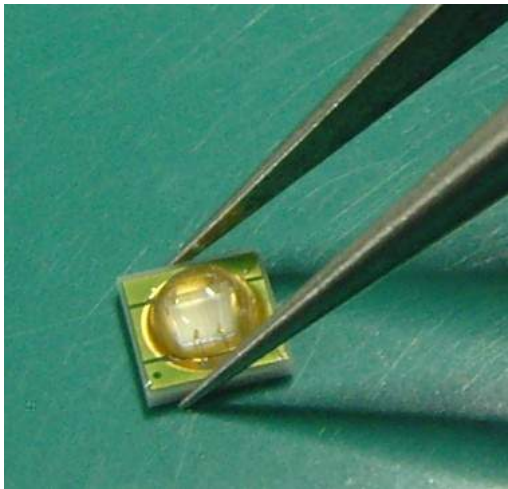

OK

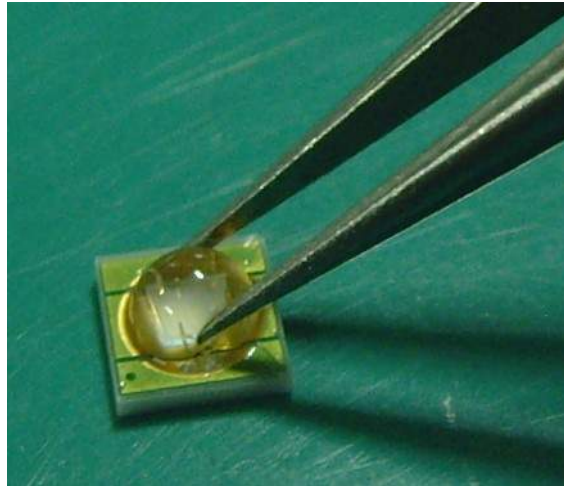

NG

Notes注

°C,

°C

°C